

## App / WiFi GUIDE - WFSTAT OPTIMUM VIBE WiFi PROGRAMMABLE THERMOSTAT



Transmitter



Receiver



**The OPTIMUM VIBE - Model WFSTAT incorporates both radio frequency and WiFi connectivity.**

The control set - when configured for T.P.I. control - meets the UK Government BEIS Department's criteria for Class IV control, contributing 2% to the energy efficiency of the system. If your heating appliance is Open Therm® compatible, the receiver's Open Therm connections can be used. Open Therm control will enable flame modulation, and this is classified as a Class VI control, contributing 4% to system efficiency. You do not need to configure Open Therm function; connection to the Open Therm terminals in the receiver will automatically initiate Open Therm operation.

The transmitter is battery-powered (2 x AAA alkaline); the receiver is mains-powered, with volt-free switching and optional Open Therm® output.

The control set uses the license - free 868 MHz radio band to communicate between transmitter and receiver. The receiver incorporates both 868MHz RF and 2.4GHz WiFi communications. The Optimum Connect C-Home App (or the Tuya Smart App) will allow control of the thermostat and receiver wherever you are, from your smart phone via your WiFi router.

**Install the C-Home App on your iOS or Android mobile phone - scan the QR code for your device below, or search C-Home on the iOS App or Google Play Store**



C-Home



Tuya Smart



**The Tuya Smart App can also be used to control your Optimum Connect devices.**

**Load the App and follow the instructions to create your user account.**

**Before** adding the thermostat in the App, make sure that you first connect the receiver via ON/OFF or Open Therm terminals, and power-up the receiver. Then add the device as noted below. It will load as an ON/OFF or Open Therm controller accordingly. If necessary, delete the device from the App, connect the receiver as described, then add the device in the App once more. The receiver must first be connected as intended, for the App to load the correct functionality.

Once the App is installed on your smart phone you can add the VIBE - WFSTAT. If you have a dual-band WiFi router, **make sure that your phone is connected to the 2.4GHz network.** You may have to separate the 2.4 GHz and 5 GHz networks in the home page of your router to do so, as smart phones will often connect to the 5GHz network by default.

In the App home screen touch the + icon (top RH corner) to add a device.

Select 'Small Home Appliances' in the left-hand column

Select 'Thermostat' from the list of devices; you may have to scroll down to find the Thermostat icon—see the partial screenshot here

Re-enter your router password (if prompted) .

Press and hold the receiver manual button until the Red Heating on LED flashes rapidly \*.

Release the button (the LED should continue flashing rapidly)

On the App, press 'Confirm' - the App will load the device. The LED will stop flashing.

The WFSTAT will display in the App Home Screen with the icon as shown here.

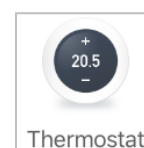
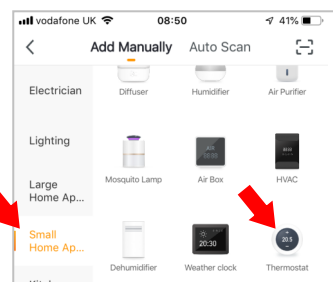

### \* Notes on LED function:

The Red 'Heating on' LED is ON or OFF indicating the output state. It flashes quickly when in Wifi or RF configuration mode. It flashes slowly if WiFi is offline or RF communication has failed.

The Green 'Power' LED is ON when connected to an Open Therm appliance, and ON - but flashes once per second - when connected to a regular ON/OFF boiler via the receiver's volt-free terminals.

Follow the instructions below to control the VIBE - WFSTAT with your smart phone.

The home screen gives access to other functions:

**Switch** - switch the transmitter (thermostat) ON or OFF.

**Note that** if you turn the thermostat OFF, whilst this will save battery power, the thermostat will no longer control the heating, which will also remain OFF.

**Setpoint** - touch the slider or  $\wedge$  /  $\vee$  to change the current temperature set-point

**Mode** - Allows you to quickly change from Auto (programmed) temperature, to Manual or ECO temperature levels. Manual and ECO temperature levels can be set from the Setpoint screen



Touch the Heating Thermostat panel icon ,  
to open access to additional functions.

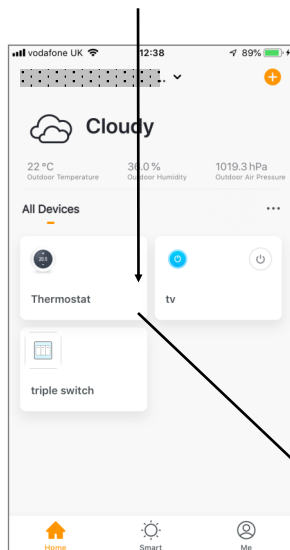

Touch the pen icon to re-name the device, and view / amend basic parameters about the device settings / functions, including device sharing, remote operation (e.g. Amazon Echo).

From here you can also remove the device from the App.

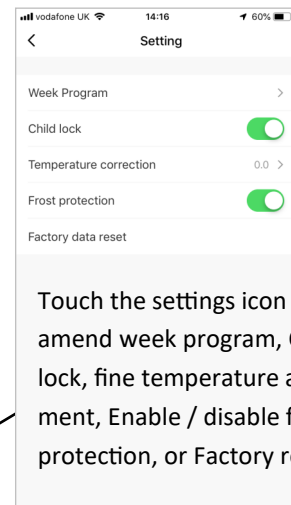

Touch the settings icon to view / amend week program, Child lock, fine temperature adjustment, Enable / disable frost protection, or Factory reset

Switch the thermostat ON or OFF (see above)

Set the Central Heating target temperature (use the slider or the  $\wedge$  /  $\vee$  arrows)

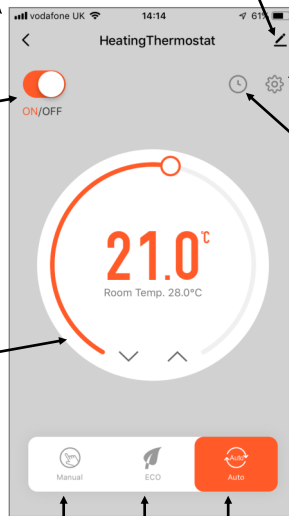

Touch the clock icon to enter a timed schedule if required. The schedule will switch the transmitter ON and OFF (and thereby enable / disable the weekly program) according to your requirements.

Use these icons to switch quickly between **Manual**, **ECO** (set your own manual or Eco temperature which is retained for next use), or **Auto** (current program or schedule in operation)

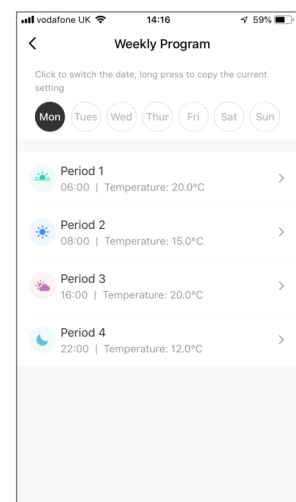

Weekly program screen:

adjust day / time / temperature programming



After the receiver has been connected to an Open Therm boiler, add the thermostat into the C-Home (or Tuya) App; an Open Therm enabled version of the App will load, giving access to flow temperature settings / real-time data views, Open Therm parameter settings and status.

**Child lock** - when using the Open Therm version of the App, Child lock can only be enabled / disabled via the App